

LAND CERTIFICATE NO. 51815 COPY

Land Certificate No. 51815 Tulcea

A. Part I. Property description LAND

within the built-up area

Address: Loc. Tulcea, Str 9 MAI, Tronson 1, Jud. Tulcea

Item no.	Cadastral number Topographic number	Surface* (sqm)	Observations / References
A1	51815	From the documents: 2,292 Measured: 2,295	Unfenced land; Land partially delimited with concrete fence and metal fence. The sidewalk and the green space were included in this area. Public domain.

B. Part II. Owners and documents

Entries regarding property rights and other real rights		References
69749 / 02/08/2022		
Administrative Act no. 310, dated 28/10/2021 issued by the Local Council of the Municipality of Tulcea, annex no. 1 to the Local Council Decision (HCL) no. 310 of 28.10.2021; Administrative Act no. 29479, dated 04/07/2022 issued by the Tulcea City Hall; Administrative Act no. 29552, dated 04/07/2022 issued by the City Hall of Tulcea Municipality; Administrative Act no. 9137, dated 30/06/2022 issued by the Tulcea Heritage Maintenance and Administration Directorate;		
B1	Tabulation, PROPERTY right, acquired by law, current share 1/1, initial share 1/1	A1
1) TULCEA MUNICIPALITY, CIF (Fiscal Identification Code): 4321429, public domain		

C. Part III. ENCUMBRANCES.

Entries regarding dismemberment of property rights, real rights of guarantee and encumbrances	References
NOT EXISTING	

Annex No. 1 To Part I

Land

Cadastral no.	Surface (sqm)*	Observations / References
51815	From the documents: 2,292 Measured: 2,295	Land partially delimited with concrete fence and metal fence. The sidewalk and the green space were included in this area. Public domain.

* The surface is determined in the Stereo 70 projection plane.

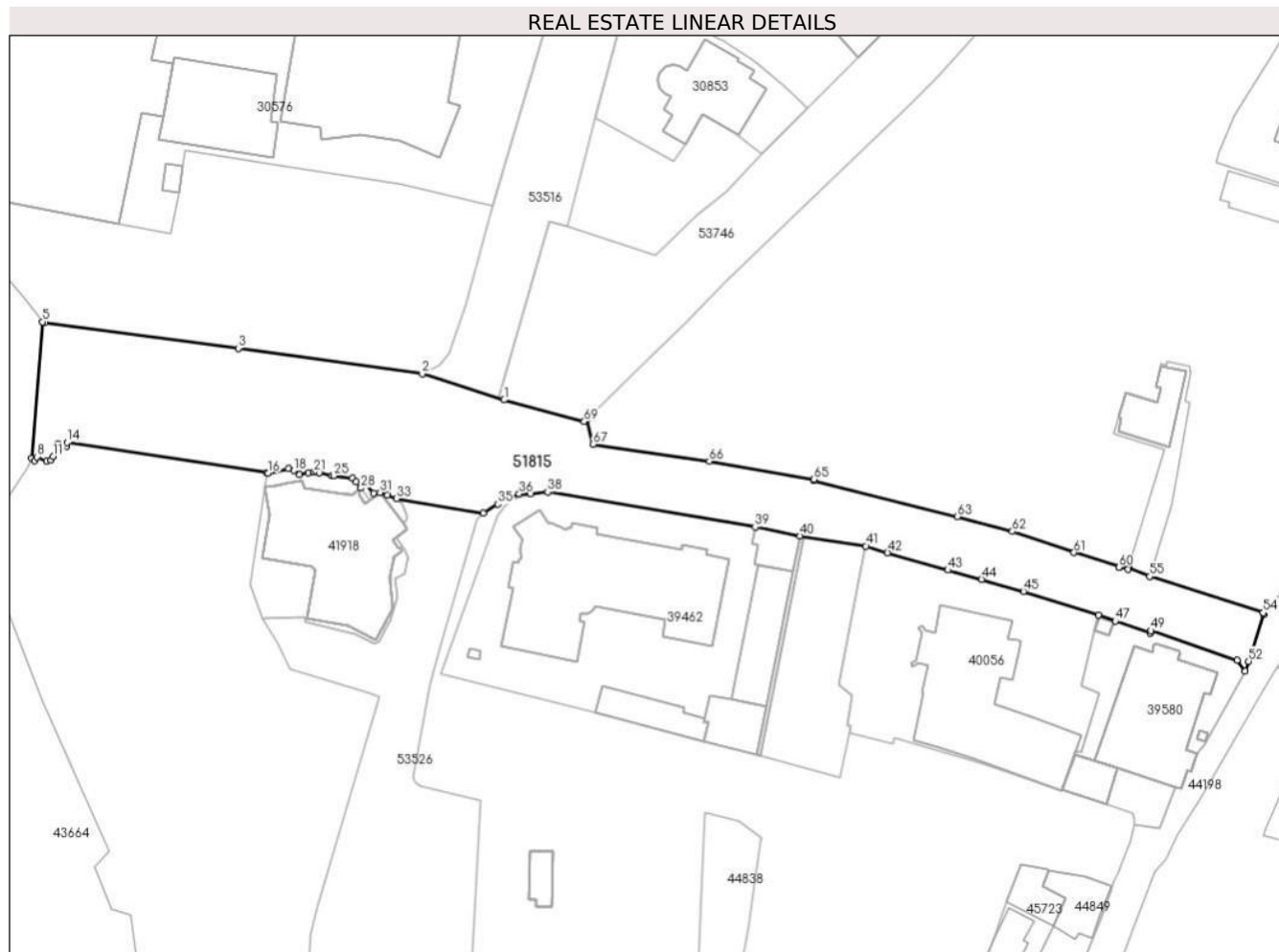

Land related data

Item no.	Usage category	Land within the built-up area	Surface (sqm)	Strip land	Lot	Topographical no.	Observations / References
1	road	YES	2,295	-	-	-	

Segments length

1) The segment length values are obtained from the plan projection.

Start point	End point	Segment length	Start point	End point	Segment length	Start point	End point	Segment length
1	2	12,979	2	3	28,032	3	4	29,391
4	5	0,446	5	6	20,726	6	7	0,559
7	8	0,629	8	9	1,623	9	10	0,619
10	11	0,659	11	12	2,029	12	13	1,235
13	14	0,563	14	15	30,508	15	16	0.2
16	17	3,148	17	18	0,847	18	19	1,057
19	20	1,317	20	21	0,897	21	22	0,346

Start point	End point	Segment length	Start point	End point	Segment length	Start point	End point	Segment length
22	23	0,48	23	24	1,929	24	25	0,282
25	26	2,913	26	27	0,771	27	28	1,165
28	29	0,984	29	30	1,755	30	31	1,002
31	32	1,219	32	33	1,405	33	34	13,334
34	35	2,59	35	36	3,523	36	37	1,681
37	38	2,674	38	39	31,726	39	40	6,92
40	41	10,058	41	42	3,425	42	43	9,489
43	44	5,252	44	45	6,58	45	46	11,864
46	47	2,711	47	48	5,622	48	49	0,389
49	50	13,807	50	51	2,099	51	52	1,606
52	53	7,468	53	54	0,275	54	55	17,919
55	56	3,453	56	57	0,202	57	58	1,35
58	59	0,1	59	60	0,072	60	61	7,128
61	62	9,821	62	63	8,602	63	64	22,331
64	65	0,193	65	66	16,041	66	67	17,786
67	68	3,904	68	69	0,604	69	1	12,523

** Segment lengths are determined in the Stereo 70 projection plane and are rounded to 1 millimeter.

*** The distance between the points is made up of cumulative segments that are smaller than the value of 1 millimeter.